



Winchester Court , London Road HP11 1HB

- Pleasant first floor flat
- Opposite parkland
- Electric heating
- Excellent transport links
- Visitor parking
- Two bedrooms
- One allocated parking space
- Newly decorated
- Bathroom with bath & shower over
- Well managed, quiet development

£1,250 Per Month



Local Authority **Wycombe District Council**
Council Tax Band C
EPC Rating

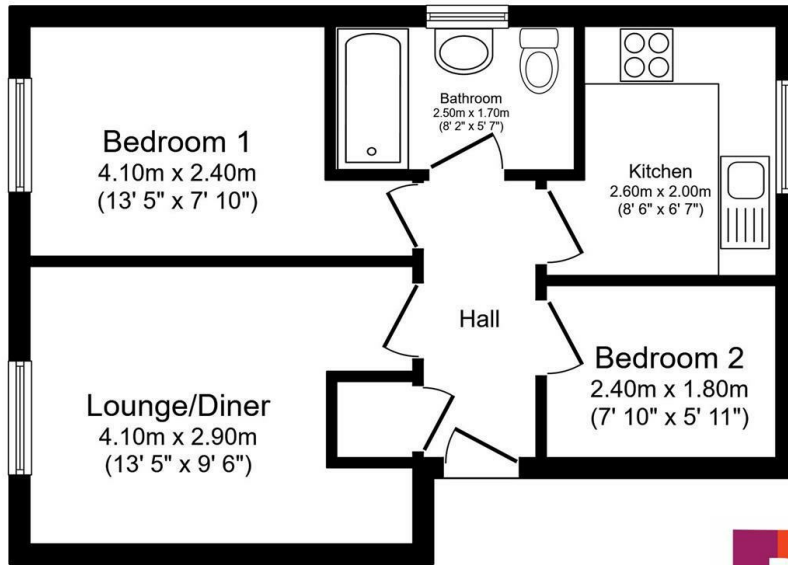

Floor Plan
Floor area 38.6 sq.m. (416 sq.ft.)

Total floor area: 38.6 sq.m. (416 sq.ft.)

This floor plan is for illustrative purposes only. It is not drawn to scale. Any measurements, floor areas (including any total floor area), openings and orientations are approximate. No details are guaranteed, they cannot be relied upon for any purpose and do not form any part of any agreement. No liability is taken for any error, omission or misstatement. A party must rely upon its own inspection(s). Powered by www.Propertybox.io



Agents Note: Whilst every care has been taken to prepare these particulars, they are for guidance purposes only. All measurements are approximate and for general guidance purposes only and whilst every care has been taken to ensure accuracy, they should not be relied upon and potential buyers/tenants are advised to recheck the measurements.



Head office Office
Red Lion House, 600 London Road, High
Wycombe, Bucks, HP11 1EX

Contact
01494 472846
contact@paulkinghamlettings.com